



KEY FEATURES:

- Produces spot-free rinse, no need to wipe
- No chamoising saves time and money, and puts an end to scratches and swirl marks.
- No hard water buildup, eliminates scaling, stains, pitting and etching
- Helps maintain paint, aluminum, chrome, and glass, leaving zero water spots
- No need for water storage tanks. Simply attach your feed water hose.
- Weighs up to 20% less than alternative units
- Intelligent control system with service indicator
- Convenient On/Off touch switch for your safety
- 100% sealed electrical plug with watertight cap
- Produces pure drinking water, eliminating the need for on-board bottled water

**SPOT-FREE RINSING
WHEREVER, WHENEVER.**

The FCI DTS+ (Dockside Treatment System) has been providing spot-free water solutions for decades. The DTS+Mobile now provides boaters with a mobile, spot-free solution from a dockside or municipal source. Simply attach your water supply hose, and enjoy purified spot-free water for rinsing. The DTS+ system removes up to 99% of total dissolved solids (TDS), purifying water as low as 5 PPM, and leads to a spot-free shine. The DTS+Mobile puts an end to tedious, time-consuming maintenance. Extend the life of your vessel's paint and wax finishes, and spend less time wiping down, polishing and applying compound. Dark colored hulls, no problem. Eliminate pitting and water spot etching, and make quick work of eisenglass, motor, galleys and metal work. With zero hard water buildup, maintaining your rods and reels, appliances and interior details (bathroom and galley fixtures) are a breeze. The purified water can also be used to fill your freshwater tank. No more cleaning the ice-maker, and do away with on-board bottled water. The cost and time-saving implications are endless. *FCI Watermakers, your reliable water source for over 30 years.*



Spot-free rinse means no swirl marks, etching or scratching.



No more chamois-drying windows, rails, and hard-to-reach areas.

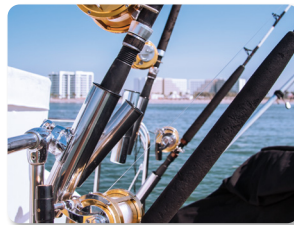

Eliminate hard water build-up on your gear, galley and appliances.



100% sealed electrical plug, and large wheels for easy mobility.

FEATURES

- ERGONOMICALLY designed handles for easy lifting
- 100% Sealed electrical plug with watertight cap
- LARGE WHEELS for easy movement and mobility
- FILTER CHANGE INDICATOR lets you know when it's time to change your filter
- ON / OFF TOUCH CONTROL SWITCH for easy use and safety

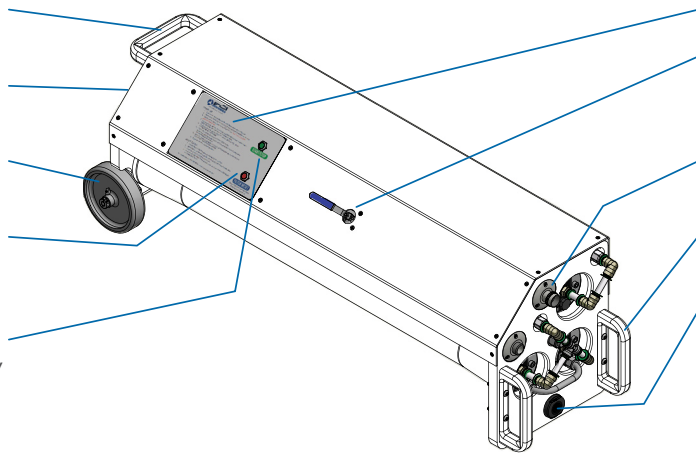

- NEMA 4X / IP 67 Rated Enclosure
- FLUSH / OPERATION VALVE uses a simple twist handle to select operation mode
- EASY-ACCESS HOSE CONNECTIONS for quick setup and take-down
- DUAL HANDLES for easy movement
- BRINE DISCHARGE automatically shuts off to save operational cost and water

DIMENSIONS

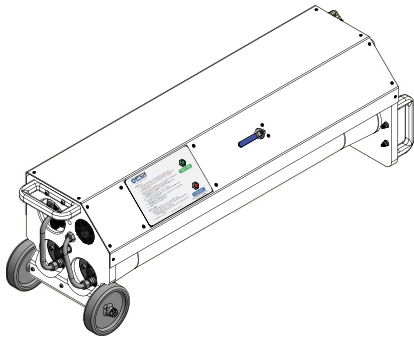

DTS+MOBILE UNIT

Width	51.30 in / 1303.02 mm
Depth	14.75 in / 374.65 mm
Height	15.38 in / 390.65 mm

AVAILABLE PRODUCT OPTIONS

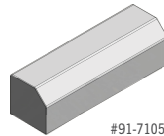

#91-7105

COVER

Width	54.00 in / 1371.60 mm
Depth	16.00 in / 406.40 mm
Height	15.25 in / 387.35 mm



#93-7380

CLEANING KIT

Width	10.07 in / 255.78 mm
Depth	12.28 in / 311.91 mm
Height	14.08 in / 357.63 mm



#93-7465

PRE-FILTER ASSEMBLY (BULKHEAD MOUNT)

Width	19.18 in / 487.17 mm
Depth	8.00 in / 203.20 mm
Height	13.88 in / 352.56 mm

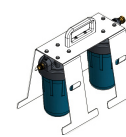

#93-7466

PRE-FILTER ASSEMBLY (GROUND MOUNT)

Width	21.63 in / 549.40 mm
Depth	12.28 in / 311.91 mm
Height	17.43 in / 442.72 mm

REQUIREMENTS

UTILITIES

Inlet Hose Connection	Wash Hose Connection	Reject
3/4" FGHT	3/4" MGHT	1/2" FNPT

ELECTRICAL

HP	KW	VAC	HZ	PH
0.5	0.37	120 / 208-240	60	1

MODEL

MODEL	Weight (LBS / KG)	Converts Dockwater to Spot-free Water	On / Off Control	Auto Shutoff Feature	120 VAC	208-240 VAC	Up to 70% Recycle Rate
DTS+Mobile-120	125 / 56.70						
DTS+Mobile-220	125 / 56.70						

System Rated Based on Typical Dock Water Conditions: Temperature 77° F / 25° C | TDS 500 | Pressure 125 PSI
System Conversion on Dock Water: Up to 1000 PPM | Chlorine Tolerance > 0.1

The Filtration Concepts Incorporated, dba FCI Watermakers, General Terms and Conditions of Sale and applicable Warranty are incorporated herein and applicable to this Product. FCI's Customer Service Department can provide Purchaser with a copy of the General Terms and Conditions of Sale upon request.