



Model # NH58263+APC Shown

KEY FEATURES:

- 7" High Resolution HMI Touch Screen that is Marine Grade and Bridge Certified
- Marine Duty Direct Drive Gearbox
- APC Fully Automated Operation and Pressure Control
- 80 sq. ft. pleated Pre-filter cartridge
- Fully Automated Fresh Water Flush System
- Also available in Vertical and Modular configurations for flexible installation options.

SUPERIOR QUALITY AND RELIABILITY YOU CAN TOUCH.

Since its inception, the FCI Neptune+ Series has been recognized for its high efficiency and extreme reliability. With output capacities ranging from 3,400 to 10,000 GPD and a dependable Direct Drive High Pressure Pump, it has proven to be a dependable workhorse by utilizing premium components: Bridge Classified touch screen, 316SS pumps, commercial filtration, NEMA 4X electrical enclosures, pressure vessels with 6x the safety factor, and industry-leading certified control systems. Add Automated Pressure Control with the corresponding media filtration skid, the Neptune+APC is the optimum system with automated watermaking at your fingertips. Vertical and Modular configurations are also available to accommodate your space and installation requirements. All configurations are ideal for commercial vessels, island homes, oil platforms, hotels, or large yachts.



Simple one-touch operation, and reliable Direct Drive Pump.

RELIABILITY AND COMPLETE AUTOMATION AT YOUR FINGERTIPS. FCI's next generation V4 controller and interface allows customization of your watermaker through intuitive advanced touch screen controls. Our monitors' higher heat tolerance and system design allow them to work in the harshest environments. FCI touch screen controllers can be installed with confidence, because they are Bridge Classified for marine use with Type Approval Certifications from: ABS, GL, Lloyd's Register EMEA, Det Norske Veritas, and Russian Maritime Register of Shipping. Rest assured, our V4 control will reliably perform for your application, and is rugged enough to last in your environment.

FCI has been manufacturing Watermakers and water purification equipment for over three decades. To ensure we exceed your expectations, we design, manufacture, program and test our units in-house for optimum quality control. Know that a company specializing in only Watermakers is here for you.

FEATURES

- **HMI TOUCH SCREEN:** 7" High-resolution, Marine Grade and Bridge Certified.
- **LP/FEED PUMP:** 316SS closed impeller design offers 50% more pressure efficiency over standard pumps.
- **MOTOR:** TEFC continuous-duty wash down rated motors with 316SS shaft, and sealed, maintenance-free bearings for long life application.
- **PRESSURE GAUGES & FLOW METERS:** Provides visual indication of critical info to aid troubleshooting.
- **DIRECT DRIVE MOTOR GEARBOX:** Marine Grade, continuous-duty with no belts to adjust, align or replace.
- **PRE-FILTER:** 80 sq. ft. of pleated filter with PVC core in addition to pressure monitoring and alarming.
- **FRAME:** 6061 Aluminum powder coated frame.
- **MEMBRANES:** High Rejection non-proprietary membranes used to obtain the highest quality of product water.
- **FRESH WATER FLUSH:** Schedule automated flushes through the V4 Control System.
- **PRODUCT VESSELS:** 316SS product/pressure ports, and FDA/NSF-51 fittings used on the product water.
- **ELECTRICAL:** NEMA 4X rated enclosure with overload protection on low pressure and high pressure pumps.
- **HIGH PRESSURE PUMP:** Continuous-duty 316SS with Pulsation Dampener.
- **AUTOMATIC PRESSURE CONTROL (APC):** Auto-adjusts system pressure to feed water conditions.

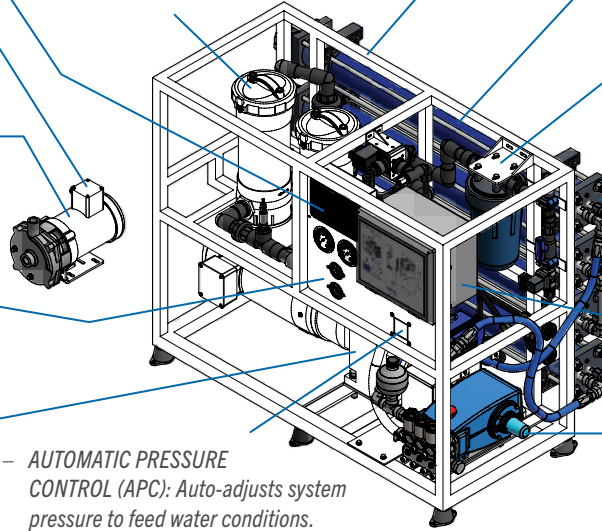

DIMENSIONS

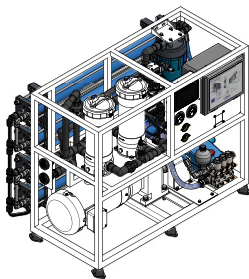

UNIT

Width Frame Only	47.50 in / 1206.50 mm
Width (3400-5800 GPD)	54.75 in / 1390.65 mm
Width (8000-10000 GPD)	94.88 in / 2409.95 mm
Depth	28.44 in / 722.38 mm
Depth Frame Only	21.50 in / 546.10 mm
Height	41.27 in / 1048.26 mm

	AVAILABLE PRODUCT OPTIONS		
	V4 REMOTE	7"	4.3"
Width	8.04 in / 204.22 mm	5.71 in / 145.03 mm	
Depth	2.13 in / 54.10 mm	2.13 in / 54.10 mm	
Height	5.64 in / 143.26 mm	4.09 in / 103.89 mm	

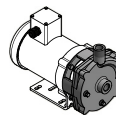
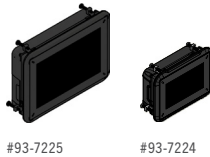

LP PUMP

Width	6.90 in / 175.26 mm
Depth	13.50 in / 342.90 mm
Height	9.15 in / 232.41 mm



Auto/Particulate:
#93-5038
Auto/Birm:
#93-5039

MEDIA FILTER

Width	21.95 in / 557.53 mm
Depth	22.78 in / 578.61 mm
Height	69.32 in / 1760.73 mm

REQUIREMENTS

UTILITIES

Inlet	Brine	Product	FWF
1" FNPT	1" FNPT	1/2" FNPT	1/2" FNPT

ELECTRICAL

HP	KW	VAC	HZ	PH
10	8.20	208-240 / 380 / 480	50 / 60	1 / 3

MODEL

Model	Weight (LBS / KG)	Seawater (GPD / LPD)	Seawater (GPH / LPH)	M3	316SS High Pressure Pump	V4 Control	Fully Automated Option	Extended Frame Dimension
NH34263+ / NH34263+APC	421 / 191	3400 / 12870.40	141.67 / 536.28	12.88	☑	☑	☑	
NH46263+ / NH46263+APC	471 / 214	4600 / 17412.89	191.67 / 725.55	17.42	☑	☑	☑	
NH58263+ / NH58263+APC	521 / 236	5800 / 21955.39	241.67 / 914.82	21.97	☑	☑	☑	
NH80263+ / NH80263+APC	655 / 297	8000 / 30283.29	333.33 / 1261.79	30.30	☑	☑	☑	☑
NH100263+ / NH100263+APC	724 / 328	10000 / 37854.12	416.67 / 1577.27	37.88	☑	☑	☑	☑

System Rated Based on Typical Sea Water Conditions: Temperature 77°F / 25°C | 32,000 TDS | Pressure 825 PSI

The Filtration Concepts Incorporated, dba FCI Watermakers, General Terms and Conditions of Sale and applicable Warranty are incorporated herein and applicable to this Product. FCI's Customer Service Department can provide Purchaser with a copy of the General Terms and Conditions of Sale upon request.